

Entineering CC8

User Manual

v1.0

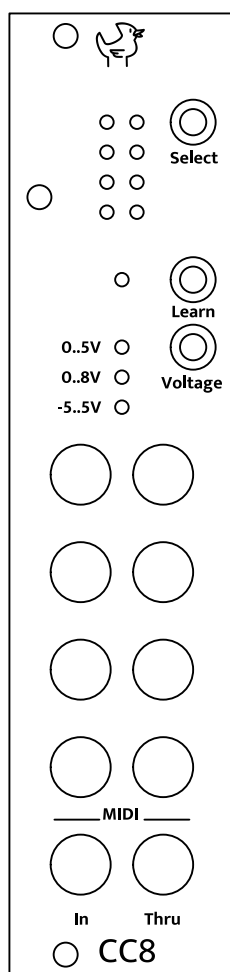

Introduction

Entineering CC8 is a module for Eurorack synthesizers. It converts MIDI Control Change messages to control voltages (CV) that can be used to control other modules.

Features of Entineering CC8 include:

- Eight individual outputs.
- Output voltage range selectable between 0..5V, 0..8V and -5..5V for each output individually.
- Easy configuration of MIDI CC messages and MIDI channels via a “Learn” functionality.

Some application examples:

- **Dynamic Modulation Control:** Use a MIDI controller’s knobs or faders to modulate various parameters on your Eurorack modules in real-time. This could be filter cutoff, resonance, oscillator pitch, etc.
- **Sequencing and Automation:** Record MIDI CC automation in a DAW (Digital Audio Workstation) and then play it back to control CV parameters in the Eurorack system. This is useful for creating evolving sequences or automated parameter changes.

Connecting the Module

Connecting Power

Your Eurorack synthesizer module comes equipped with a 16-pin keyed connector for power supply.

To connect the module:

1. **Power Off Your System:** Before connecting the module, ensure that your Eurorack case and power supply are turned off.
2. **Locate the Power Connection on Your Case:** Identify the power headers on your Eurorack case. These headers will also have a 16-pin connector.
3. **Use the supplied ribbon cable to connect the module to your Eurorack power supply.** The red mark on the ribbon cable identifies the -12V supply line. On the module, the red mark points towards the bottom on the module.

4. Secure the Module: Once connected, mount your module into the case using the appropriate screws, ensuring it is securely in place.

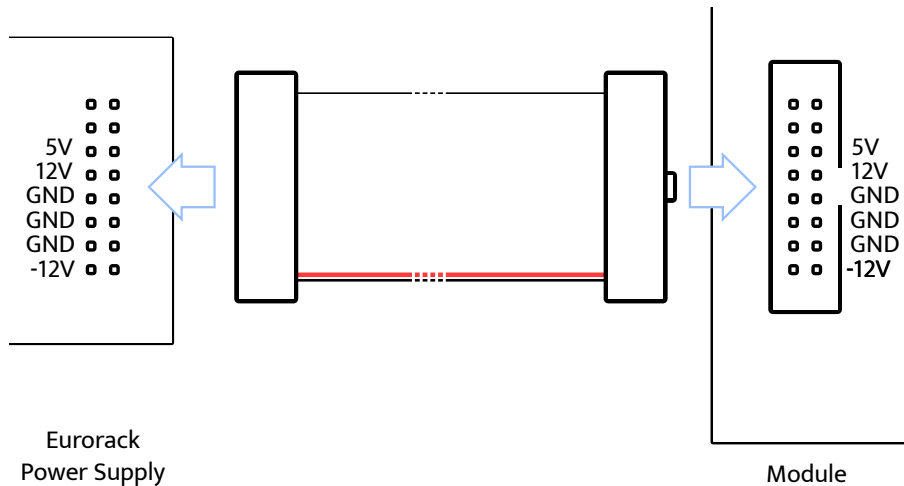

Only use proper Eurorack power supplies with voltages of -12V, +12V and +5V.

Connecting MIDI

To connect a device with a 5-pin DIN connector to the module, you need a MIDI DIN-to-TRS adapter. The TRS jacks on the module use the A pinout that is now included in the official MIDI standard.

To be able to send MIDI data to the module, connect the MIDI Out or MIDI Thru port of your MIDI keyboard, audio interface or similar, to the MIDI In jack of the module.

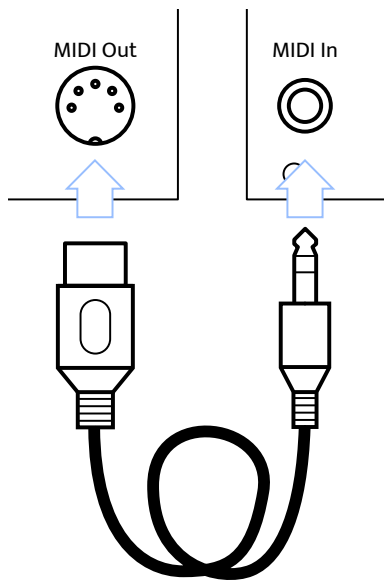

Using the Module

Configuring the CC Message for an Output

- Press the Select button to cycle through the outputs. Press the button repeatedly until the indicator for the desired output is blinking.
- Press the Learn button. The indicators for both the output and for Learn are blinking.
- Move or modify the MIDI controller you want to assign to that output.
- The output indicators will play an animation to indicate the new assignment.

Configuring the Output Voltage Range

- Press the Select button to cycle through the outputs. Press the button repeatedly until the indicator for the desired output is blinking.
- Press the Voltage button to select the voltage range.