

---

# Entineering Convolution

User Manual

v1.0.1

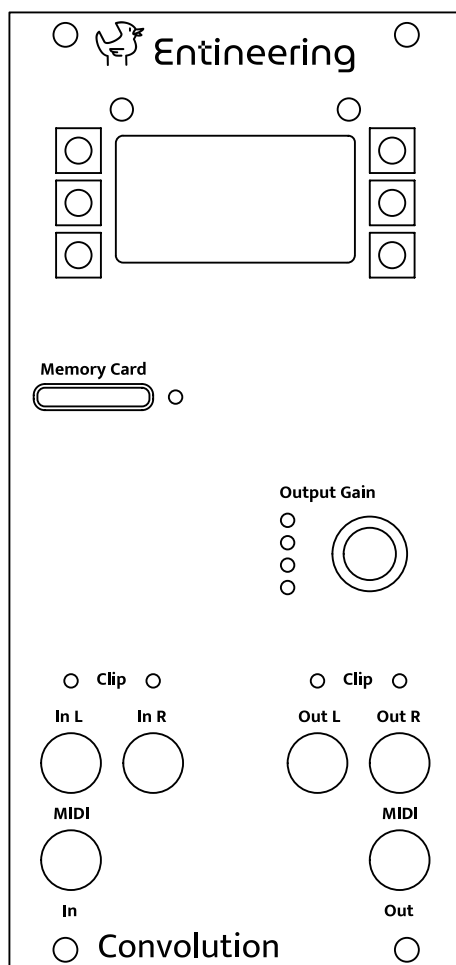

## Introduction

A convolution is a mathematical operation that combines two signals to produce a new one. It's often used to apply effects, like reverb, by taking the sound of a room or environment (called an impulse response) and blending it with an audio signal. This makes the audio sound as if it's being played in that specific space.

Enteeneering Convolution is a module for Eurorack synthesizers that does digital convolution of an analog audio signal with an impulse response that is loaded from a memory card or from internal memory.

## Features

- Up to 4 seconds of impulse response at 48 kHz
- Ultra-low latency down to 1 millisecond
- 24 bit A/D and D/A conversion
- 32 bit floating point processing
- Reads impulse response files from memory card
- Integrated example impulse response files
- Mono-to-stereo and stereo-to-stereo (parallel stereo and four-way) processing
- 1.3 inch OLED display
- Firmware updates via memory card
- 99 user presets, selectable via MIDI CC commands

## Typical Applications

### Reverb

The most common use of convolution in audio production is the use as high-quality reverb. Impulse responses can be recorded from pretty much any physical room, from famous recording studios to churches or parking garages. Impulse responses also exist from expensive outboard gear like plate reverbs or dedicated rack units.

### Speaker Cabinet Simulation

A speaker cabinet is in essence just a very small room. Impulse responses can also be recorded with different microphone positions in front of the speaker. This applica-

tion is interesting for processing amplified guitar signals without the hassle of using a real speaker cabinet.

## Experimental Applications

The impulse response that is used for convolution is just an audio file. There is no requirement that it is even an actual impulse response. Any sound works! Although it works best if either the input signal or the impulse response is of percussive nature, there is really no limit to the imagination.

## Limitations

Apart from the limitation imposed by the finite processing power of the module (outlined above under “Features”), there is an inherent limitation to what convolution can do: It can only reproduce **Linear, time-invariant (LTI) systems**.

- **Linear** means, for example, that an input signal that is twice as loud always produces an output signal that is twice as loud. Thus, convolution can not reproduce any form of distortion. A guitar amplifier for example can not be represented by an impulse response.
- **Time-invariant** means, for example, that an input signal that occurs a second later causes the output signal to occur a second later, with no other side-effects. This excludes, for example, a tape echo with varying speed.

In recent years, equipment has become commercially available that can indeed record and reproduce the response of distortion pedals and amplifiers. But this is not done just by convolution. Other forms of signal processing are required to achieve this.

## Connecting the Module

### Connecting Power

Your Eurorack synthesizer module comes equipped with a 10-pin keyed connector for power supply.

To connect the module:

1. **Power Off Your System:** Before connecting the module, ensure that your Eurorack case and power supply are turned off.
2. **Locate the Power Connection on Your Case:** Identify the power headers on your Eurorack case. These headers will have a 16-pin connector.
3. **Use the supplied ribbon cable to connect the module to your Eurorack power supply.** The red mark on the ribbon cable identifies the -12V supply line. On the module, the red mark points towards the bottom on the module.
4. **Secure the Module:** Once connected, mount your module into the case using the appropriate screws, ensuring it is securely in place.

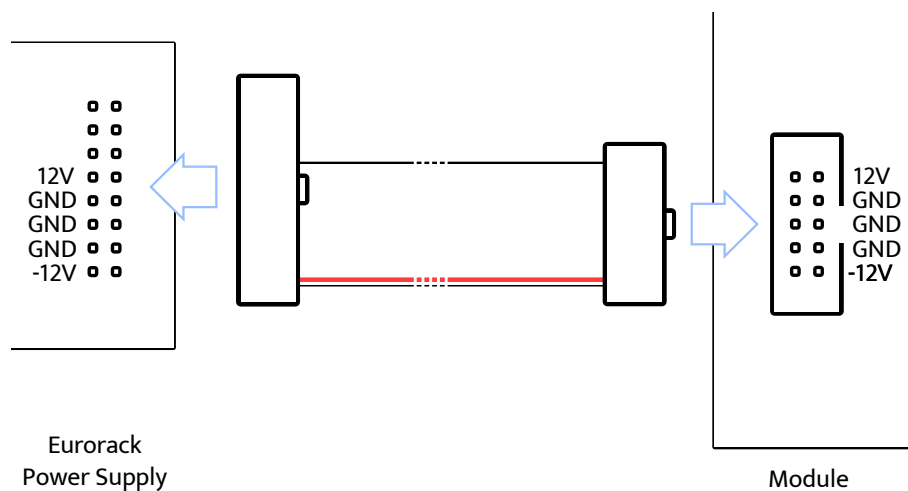

**Figure 1:** Connecting Power



Only use proper Eurorack power supplies with voltages of -12V and +12V.

## Connecting MIDI

To connect a device with a 5-pin DIN connector to the module, you need a MIDI DIN-to-TRS adapter. The TRS jacks on the module use the A pinout that is now included in the official MIDI standard.

To be able to send MIDI data to the module, connect the MIDI Out or MIDI Thru port of your MIDI keyboard, audio interface or similar, to the MIDI In jack of the module.

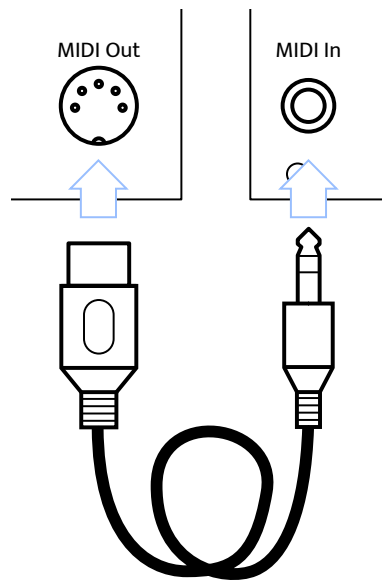

**Figure 2:** Connecting MIDI

## Using the Module

### General Interaction

Interaction with the module happens mainly via the OLED screen and the six buttons around it. Functions on the screen can be activated with the button next to it.

### Inserting a Memory Card

Several example impulse response files are included on the internal memory of the module. To use your own impulse response files, copy them onto a Micro\* card formatted as FAT32. Insert the card into the slot labelled “Memory Card” before turning on the module.

The memory card slot is only scanned when the module starts up. Inserting or removing the memory card while the module is turned on is not supported at this time.

### Selecting an Impulse Response

To select a sound file to use as an impulse response, follow these steps:

1. While on the main screen, press the lower right button, which says “Select IR” next to it.
2. Choose the source of the file. Either the internal storage or the memory card.
3. Navigate to the file you want to use as impulse response.
4. Select a processing profile for the file.



**Figure 3:** Impulse response selection.

### Profiles

Processing profiles let you choose between different trade-offs like shorter latency vs. longer impulse response, or different channel configurations. The available profiles depend on the selected file, like its sampling rate and number of channels.

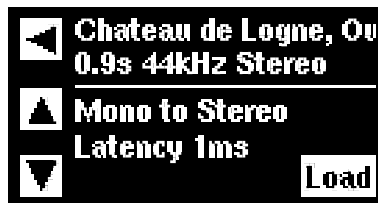

**Figure 4:** Profile selection.

**Mono to Stereo** Here, a monaural input signal (fed into the module through the left input channel) is convoluted with the left channel of the impules response to produce the right output channel. The same input signal is also convoluted with the right channel of the impulse response to produce the right output signal.

This is by far the most common and most useful type of multi-channel convolution. In term of room acoustics, this transatles to an omnidirectional sound source, reverberated by the room, and experienced by a human listener, or recorded by a stereo microphone setup.

**Parallel Stereo** With this setting, the left input channel is convoluted with the left channel of the impulse response, and the result is fed to the left output channel. Accordingly, the right input convoluted with the right impulse response channel goes to the right output channel.

If this setup has a physical representation depends on the impulse response file. But most of the time, stereo impulse response files are meant for Mono to Stereo setups.

**Four Channel “True Stereo”** Four-channel impulse response files are required to use this mode.

- The left input channel is convoluted with channel 1 of the impulse response to produce the left output channel.
- The left input channel is convoluted with channel 2 of the IR to produce the right output signal.
- The right input channel is convoluted with channel 3 of the IR and mixed into the left output channel.
- The right input channel is convoluted with channel 4 of the IR and mixed into the right output channel.

A physical representation of this would be a stereo speaker system and a stereo listener in a room. From two speakers to two ears or microphones there is a total of four paths.



Many true-stereo impulse responses you find on the web are distributed as two stereo files. Use your favorite audio editing software to combine them into a single four-channel audio file.

Pay attention to the channel order. Entineering Convolution uses the channel order L->L, L->R, R->L, R->R.



Many four-channel impulse response files you find on the web are encoded in the so-called B-format. This is a special surround-sound format which uses W, X, Y and Z channels instead of left and right channels. The Convolution module will load such files (because there is no way to distinguish the file format), but the result will not be anything meaningful. Pay attention if the file name or accompanying documentation mentions the B-format anywhere.

## Adjusting Output Gain

Convolution can significantly increase the overall signal amplitude, especially if the impulse response used has high energy. Adjusting the output level prevents clipping and maintains proper headroom.

To adjust the output gain, turn the encoder knob on the front panel. Turning clockwise increases the gain, while turning counter-clockwise decreases it. Output gain can be adjusted between -30 and +10 dB.

If you see the “Clip” LEDs next to the output jacks light up, then the output gain is too high and you have to decrease it. If, on the other hand, audio output is too low, increase the output gain until the clip LEDs light up occasionally, then go back a bit until they stay off.

## Saving and Loading Programs

Parameters can be saved as programs and later restored. 99 program slots are available. The following parameters are stored with each program:

- The path to the impulse response file (either on internal memory or on a memory card)
- The selected profile
- Output gain



The impulse response data itself is not stored, only the path to the file. This means that if the memory card is removed, swapped with another one or the file on the card is moved, removed or renamed, the program cannot be loaded.



## Saving a Program

To save a program, press the upper right button while the “Save” label lights up on the screen. Use the buttons labelled with arrows to select a slot number, or keep the currently selected slot. Then press the “Save” button again to complete the procedure.

## Restoring a Program

There are two ways to restore a program:

- Via the buttons on the module
- Via MIDI Program Change (PC) messages

Use the buttons next to up and down arrows while on the main screen to select the next and previous program respectively. The current program number and the associated file name are displayed on the screen.

MIDI Program Change messages can be sent from a controller keyboard, sequencer, DAW or similar device or software. If a MIDI channel is configured, only PC messages on that channel are taken into account. Other messages are ignored. The MIDI channel of the module can be configured in the settings menu.



Loading an impulse response file takes a few seconds.

## Main Menu

The main menu can be accessed by pressing the upper left button while the “Menu” label is visible.



**Figure 5:** Main menu.

## MIDI Channel

Use this menu item to configure the MIDI channel the module listens on, or “All” to listen on all channels. The module listens for Program Change (PC) MIDI messages on the configured channel(s).

## Firmware Version

Use this to see the currently installed firmware version. Check <https://entineering.eu> to see if a newer firmware version is available. See the next section on how to install the new firmware.

## Firmware Update

To update the firmware of the module:

- Go to <https://entineering.eu> to download a new firmware file.
- Copy the file onto a FAT32-formatted memory card.
- Insert the memory card into the module.
- Turn on the power supply for the module.
- Press the button labelled “Menu”, then navigate to “Firmware Update”.
- Select the file on the memory card.



Ensure a stable power supply during the update! If power gets interrupted while the firmware file is written to the module, the module will no longer be operational. Additional tools and knowledge are required to recover from this state.

In case of problems after a firmware update, you can try a factory reset using the method described in the next section.

## Factory Reset

This menu option deletes all saved programs and resets all settings like MIDI channel to their default value.

A factory reset can also be done the following way: - Power down the module. - Press and hold the left center and left bottom soft buttons. - Turn on power to the module. - Release the buttons. - Wait until the blinking “Factory reset” disappears from the screen and the module reboots into the main screen.

## Appendix A: Convolution Profiles

A convolution profile is a set of parameters the module uses internally to handle its calculations. Depending on impulse response sampling rate and channel count, different convolution profiles are available. In some cases, multiple profiles are available for the same mode. In these cases, there are tradeoffs between latency and maximum IR length.

**Table 1:** List of convolution profiles

Mode	Sampling Rate	Max IR Length	Latency
Mono to Stereo	44100 Hz	4.2 s	1 ms
Parallel Stereo	44100 Hz	3.7 s	2 ms
Mono to Stereo	48000 Hz	3.3 s	2 ms
Mono to Stereo	48000 Hz	4.4 s	5 ms
True Stereo	44100 Hz	0.8 s	5 ms
Mono	44100 Hz	6.4 s	1 ms
Mono	48000 Hz	5.9 s	1 ms

Check <https://entineering.eu> for firmware updates which might improve and extend this list as the firmware is optimized.

## Appendix B: Attributions

### u8g2

This product uses the u8g2 software library, copyright by Oli Kraus, licensed under the following terms:

Universal 8bit Graphics Library (<https://github.com/olikraus/u8g2>)

Copyright (c) 2016, olikraus@gmail.com

All rights reserved.

Redistribution and use in source and binary forms, with or without modification, are permitted provided that the following conditions are met:

- \* Redistributions of source code must retain the above copyright notice, this list of conditions and the following disclaimer.
- \* Redistributions in binary form must reproduce the above copyright notice, this list of conditions and the following disclaimer in the documentation and/or other materials provided with the distribution.

THIS SOFTWARE IS PROVIDED BY THE COPYRIGHT HOLDERS AND CONTRIBUTORS "AS IS" AND ANY EXPRESS OR IMPLIED WARRANTIES, INCLUDING, BUT NOT LIMITED TO, THE IMPLIED WARRANTIES OF MERCHANTABILITY AND FITNESS FOR A PARTICULAR PURPOSE ARE DISCLAIMED. IN NO EVENT SHALL THE COPYRIGHT HOLDER OR CONTRIBUTORS BE LIABLE FOR ANY DIRECT, INDIRECT, INCIDENTAL, SPECIAL, EXEMPLARY, OR CONSEQUENTIAL DAMAGES (INCLUDING, BUT NOT LIMITED TO, PROCUREMENT OF SUBSTITUTE GOODS OR SERVICES; LOSS OF USE, DATA, OR PROFITS; OR BUSINESS INTERRUPTION) HOWEVER CAUSED AND ON ANY THEORY OF LIABILITY, WHETHER IN CONTRACT, STRICT LIABILITY, OR TORT (INCLUDING NEGLIGENCE OR OTHERWISE) ARISING IN ANY WAY OUT OF THE USE OF THIS SOFTWARE, EVEN IF ADVISED OF THE POSSIBILITY OF SUCH DAMAGE.

## **KISS FFT**

This product uses the KISS FFT library, copyright 2003-2010 Mark Borgerding, licensed under the following terms:

Copyright (c) 2003-2010 Mark Borgerding. All rights reserved.

Redistribution and use in source and binary forms, with or without modification, are permitted provided that the following conditions are met:

1. Redistributions of source code must retain the above copyright notice, this list of conditions and the following disclaimer.
2. Redistributions in binary form must reproduce the above copyright notice, this list of conditions and the following disclaimer in the documentation and/or other materials provided with the distribution.
3. Neither the name of the copyright holder nor the names of its contributors may be used to endorse or promote products derived from this software without specific prior written permission.

THIS SOFTWARE IS PROVIDED BY THE COPYRIGHT HOLDERS AND CONTRIBUTORS "AS IS" AND ANY EXPRESS OR IMPLIED WARRANTIES, INCLUDING, BUT NOT LIMITED TO, THE IMPLIED WARRANTIES OF MERCHANTABILITY AND FITNESS FOR A PARTICULAR PURPOSE ARE DISCLAIMED. IN NO EVENT SHALL THE COPYRIGHT HOLDER OR CONTRIBUTORS BE LIABLE FOR ANY DIRECT, INDIRECT, INCIDENTAL, SPECIAL, EXEMPLARY, OR CONSEQUENTIAL DAMAGES (INCLUDING, BUT NOT LIMITED TO, PROCUREMENT OF SUBSTITUTE GOODS OR SERVICES; LOSS OF USE, DATA, OR PROFITS; OR BUSINESS INTERRUPTION) HOWEVER CAUSED AND ON ANY THEORY OF LIABILITY, WHETHER IN CONTRACT, STRICT LIABILITY, OR TORT (INCLUDING NEGLIGENCE OR OTHERWISE) ARISING IN ANY WAY OUT OF THE USE OF THIS SOFTWARE, EVEN IF ADVISED OF THE POSSIBILITY OF SUCH DAMAGE.

### **Example Impulse Responses**

The impulse response files on the module's internal memory are included as examples free of charge. They can also be downloaded from <https://enteeneering.eu>, again free of charge.

All impulses in this archive were created with Impulse Modeler that can be downloaded at <http://www.voxengo.com/imodeler/>

By extracting and using provided impulse files you signify acceptance of the following terms and conditions:

1. All copyrights to these impulse files are exclusively owned by the Distributor - Aleksey Vaneev. All rights not expressly granted here are reserved by Aleksey Vaneev.

2. Permission is granted to anyone to use these impulse files royalty-free for any purpose, including commercial usage.
  3. You may not sell these impulse files or earn any direct or indirect profit from their distribution.
  4. You may not copy and distribute these impulse files in whole or in part unless:
    - a) the copyright notice and this list of conditions appear on all copies;
    - b) copies are complete and unaltered with all messages intact;
    - c) no charge is associated with the distribution of such copies;and
    - d) any distribution made by you hereunder is expressly made subject to an acknowledgment by you and the recipient of such distribution that Aleksey Vaneev retains exclusive ownership of these impulse files including all intellectual property rights therein, at all times.
  5. THESE IMPULSE FILES ARE PROVIDED "AS IS" WITHOUT WARRANTY OF ANY KIND, EITHER EXPRESS OR IMPLIED, INCLUDING BUT NOT LIMITED TO, THE IMPLIED WARRANTIES OF MERCHANTABILITY, FITNESS FOR A PARTICULAR PURPOSE, NON-INFRINGEMENT OR ARISING FROM A COURSE OF DEALING, USAGE, TRADE OR PRACTICE. Some jurisdictions do not allow the exclusion of implied warranties, so the above disclaimer may not apply to you.
- IN NO EVENT SHALL THE DISTRIBUTOR BE LIABLE FOR ANY SPECIAL, DIRECT, INDIRECT, OR CONSEQUENTIAL DAMAGES OR ANY DAMAGES WHATSOEVER RESULTING FROM LOSS OF USE, DATA OR PROFITS, WHETHER IN AN ACTION OF CONTRACT, NEGLIGENCE OR OTHER TORTIOUS ACTION, ARISING OUT OF OR IN CONNECTION WITH THE USE OR PERFORMANCE OF THESE IMPULSE FILES.

## **Arm CMSIS**

This product uses parts of Arm CMSIS, copyright (C) 2010-2021 ARM Limited or its affiliates, licensed under the Apache 2.0 license.

Apache License

Version 2.0, January 2004

<http://www.apache.org/licenses/>

## TERMS AND CONDITIONS FOR USE, REPRODUCTION, AND DISTRIBUTION

### 1. Definitions.

"License" shall mean the terms and conditions for use, reproduction, and distribution as defined by Sections 1 through 9 of this document.

"Licensor" shall mean the copyright owner or entity authorized by the copyright owner that is granting the License.

"Legal Entity" shall mean the union of the acting entity and all other entities that control, are controlled by, or are under common control with that entity. For the purposes of this definition, "control" means (i) the power, direct or indirect, to cause the direction or management of such entity, whether by contract or otherwise, or (ii) ownership of fifty percent (50%) or more of the outstanding shares, or (iii) beneficial ownership of such entity.

"You" (or "Your") shall mean an individual or Legal Entity exercising permissions granted by this License.

"Source" form shall mean the preferred form for making modifications, including but not limited to software source code, documentation source, and configuration files.

"Object" form shall mean any form resulting from mechanical transformation or translation of a Source form, including but not limited to compiled object code, generated documentation, and conversions to other media types.

"Work" shall mean the work of authorship, whether in Source or Object form, made available under the License, as indicated by a copyright notice that is included in or attached to the work (an example is provided in the Appendix below).

"Derivative Works" shall mean any work, whether in Source or Object form, that is based on (or derived from) the Work and for which the editorial revisions, annotations, elaborations, or other modifications represent, as a whole, an original work of authorship. For the purposes of this License, Derivative Works shall not include works that remain separable from, or merely link (or bind by name) to the interfaces of, the Work and Derivative Works thereof.

"Contribution" shall mean any work of authorship, including the original version of the Work and any modifications or additions to that Work or Derivative Works thereof, that is intentionally submitted to Licensor for inclusion in the Work by the copyright owner or by an individual or Legal Entity authorized to submit on behalf of the copyright owner. For the purposes of this definition, "submitted" means any form of electronic, verbal, or written communication sent to the Licensor or its representatives, including but not limited to communication on electronic mailing lists, source code control systems, and issue tracking systems that are managed by, or on behalf of, the Licensor for the purpose of discussing and improving the Work, but excluding communication that is conspicuously marked or otherwise designated in writing by the copyright owner as "Not a Contribution."

"Contributor" shall mean Licensor and any individual or Legal Entity on behalf of whom a Contribution has been received by Licensor and subsequently incorporated within the Work.

2. Grant of Copyright License. Subject to the terms and conditions of this License, each Contributor hereby grants to You a perpetual, worldwide, non-exclusive, no-charge, royalty-free, irrevocable copyright license to reproduce, prepare Derivative Works of, publicly display, publicly perform, sublicense, and distribute the Work and such Derivative Works in Source or Object form.

3. Grant of Patent License. Subject to the terms and conditions of this License, each Contributor hereby grants to You a perpetual, worldwide, non-exclusive, no-charge, royalty-free, irrevocable (except as stated in this section) patent license to make, have made,



use, offer to sell, sell, import, and otherwise transfer the Work, where such license applies only to those patent claims licensable by such Contributor that are necessarily infringed by their Contribution(s) alone or by combination of their Contribution(s) with the Work to which such Contribution(s) was submitted. If You institute patent litigation against any entity (including a cross-claim or counterclaim in a lawsuit) alleging that the Work or a Contribution incorporated within the Work constitutes direct or contributory patent infringement, then any patent licenses granted to You under this License for that Work shall terminate as of the date such litigation is filed.

4. Redistribution. You may reproduce and distribute copies of the Work or Derivative Works thereof in any medium, with or without modifications, and in Source or Object form, provided that You meet the following conditions:

(a) You must give any other recipients of the Work or Derivative Works a copy of this License; and

(b) You must cause any modified files to carry prominent notices stating that You changed the files; and

(c) You must retain, in the Source form of any Derivative Works that You distribute, all copyright, patent, trademark, and attribution notices from the Source form of the Work, excluding those notices that do not pertain to any part of the Derivative Works; and

(d) If the Work includes a "NOTICE" text file as part of its distribution, then any Derivative Works that You distribute must include a readable copy of the attribution notices contained within such NOTICE file, excluding those notices that do not pertain to any part of the Derivative Works, in at least one of the following places: within a NOTICE text file distributed as part of the Derivative Works; within the Source form or documentation, if provided along with the Derivative Works; or, within a display generated by the Derivative Works, if and

wherever such third-party notices normally appear. The contents of the NOTICE file are for informational purposes only and do not modify the License. You may add Your own attribution notices within Derivative Works that You distribute, alongside or as an addendum to the NOTICE text from the Work, provided that such additional attribution notices cannot be construed as modifying the License.

You may add Your own copyright statement to Your modifications and may provide additional or different license terms and conditions for use, reproduction, or distribution of Your modifications, or for any such Derivative Works as a whole, provided Your use, reproduction, and distribution of the Work otherwise complies with the conditions stated in this License.

5. Submission of Contributions. Unless You explicitly state otherwise, any Contribution intentionally submitted for inclusion in the Work by You to the Licensor shall be under the terms and conditions of this License, without any additional terms or conditions. Notwithstanding the above, nothing herein shall supersede or modify the terms of any separate license agreement you may have executed with Licensor regarding such Contributions.

6. Trademarks. This License does not grant permission to use the trade names, trademarks, service marks, or product names of the Licensor, except as required for reasonable and customary use in describing the origin of the Work and reproducing the content of the NOTICE file.

7. Disclaimer of Warranty. Unless required by applicable law or agreed to in writing, Licensor provides the Work (and each Contributor provides its Contributions) on an "AS IS" BASIS, WITHOUT WARRANTIES OR CONDITIONS OF ANY KIND, either express or implied, including, without limitation, any warranties or conditions of TITLE, NON-INFRINGEMENT, MERCHANTABILITY, or FITNESS FOR A PARTICULAR PURPOSE. You are solely responsible for determining the appropriateness of using or redistributing the Work and assume any risks associated with Your exercise of permissions under this License.

8. Limitation of Liability. In no event and under no legal theory, whether in tort (including negligence), contract, or otherwise, unless required by applicable law (such as deliberate and grossly negligent acts) or agreed to in writing, shall any Contributor be liable to You for damages, including any direct, indirect, special, incidental, or consequential damages of any character arising as a result of this License or out of the use or inability to use the Work (including but not limited to damages for loss of goodwill, work stoppage, computer failure or malfunction, or any and all other commercial damages or losses), even if such Contributor has been advised of the possibility of such damages.

9. Accepting Warranty or Additional Liability. While redistributing the Work or Derivative Works thereof, You may choose to offer, and charge a fee for, acceptance of support, warranty, indemnity, or other liability obligations and/or rights consistent with this License. However, in accepting such obligations, You may act only on Your own behalf and on Your sole responsibility, not on behalf of any other Contributor, and only if You agree to indemnify, defend, and hold each Contributor harmless for any liability incurred by, or claims asserted against, such Contributor by reason of your accepting any such warranty or additional liability.

#### END OF TERMS AND CONDITIONS

#### APPENDIX: How to apply the Apache License to your work.

To apply the Apache License to your work, attach the following boilerplate notice, with the fields enclosed by brackets "{}" replaced with your own identifying information. (Don't include the brackets!) The text should be enclosed in the appropriate comment syntax for the file format. We also recommend that a file or class name and description of purpose be included on the same "printed page" as the copyright notice for easier identification within third-party archives.

Copyright {yyyy} {name of copyright owner}

Licensed under the Apache License, Version 2.0 (the "License");  
you may not use this file except in compliance with the License.  
You may obtain a copy of the License at

<http://www.apache.org/licenses/LICENSE-2.0>

Unless required by applicable law or agreed to in writing, software  
distributed under the License is distributed on an "AS IS" BASIS,  
WITHOUT WARRANTIES OR CONDITIONS OF ANY KIND, either express or implied.  
See the License for the specific language governing permissions and  
limitations under the License.

## **Canaan**

This product uses software from Canaan Inc., copyright 2018, licensed under the  
terms of the Apache 2.0 license. Please see the previous section for the full license  
text.

## **Apache NuttX**

This product uses software from The Apache Software Foundation, copyright 2020,  
licensed under the terms of the Apache 2.0 license. Please see the previous section  
for the full license text.

Apache NuttX

Copyright 2020 The Apache Software Foundation

This product includes software developed at  
The Apache Software Foundation (<http://www.apache.org/>).